

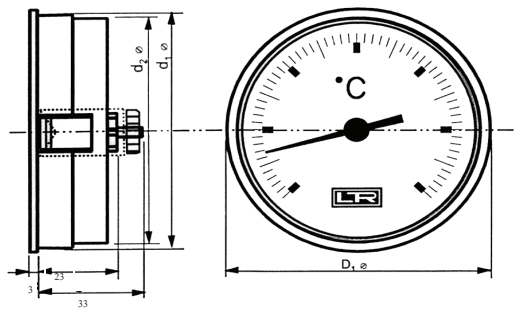

Dial Thermometers Type K3

K3 Dial Thermometer

Dial Size	52, 60 & 100 mm
Case	ABS
Mountings	Surface / Wall mount - (SM) Panel mount with clips - (CL) Panel mount with bracket - (BR) Panel mount with front flange - (FF)
Ranges	-40 to 350° Celsius
Accuracy	+ / - 3%
Probe	7.2 mm diameter (Copper)
Capillary	3000 mm - PVC coated copper capillary to 120°C Copper braided capillary above 120°C



TYPE	1052 K3*	1060 K3	1100 K3
d ₁ Ø	52	60	98
d ₂ Ø	—	—	96
D ₁ Ø	57	65.5	103
Bracket	—	65 x 26	104 x 26

Stock Items: (for pricing see page 6 of Item Price List)

Dial Size	Range	Part No.
52 mm	-40 to + 40°C	1052 K3/xx 40-40
	0 to 120°C	1052 K3/xx 120
	0 to 250°C	1052 K3/xx 250
	0 to 350°C	1052 K3/xx 350
60 mm	-40 to + 40°C	1060 K3/xx 40-40
	0 to 120°C	1060 K3/xx 120
	0 to 250°C	1060 K3/xx 250
	0 to 350°C	1060 K3/xx 350
100 mm	-40 to + 40°C	1100 K3/xx 40-40
	0 to 120°C	1100 K3/xx 120
	0 to 250°C	1100 K3/xx 250
	0 to 350°C	1100 K3/xx 350
Ex Stock Options		Part No.
Brass pocket with 1/8" NPT connection		617 152 999

How to order:

Using the part numbers above and the mounting codes listed in the first table, replace **xx** with the mounting code of your required configuration.

For example a 100 mm, 0-120°, surface mount gauge would be as follows: 1100 K3/**SM** 120

All prices exclude GST. We reserve the right to change technical specifications & prices without prior notice.